

# COMMON MODE CHOKE

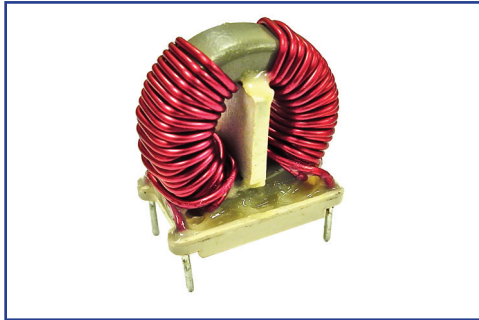

## P52TM25 SERIES



- Toroidal core type common mode choke
- Dielectric withstanding voltage: 2000 Vrms (between windings)
- Operating temperature range: -40°C to +85°C
- Vertical mount version (horizontal mount version and custom design available upon request)
- RoHS compliant product

### ELECTRICAL PARAMETERS @ 25°C

Part Number	Inductance (mH) (Min)	Rated Irms (A)	DCR (mΩ MAX)	Dimension A (inch Max)	Dimension B (inch Max)	Dimension C (±0.010 inch)	Dimension D (±0.010 inch)	Dimension E (inch Max)	Dimension F (±0.005 inch)
P52TM25-402-14.5	4.0	14.50	12	1.70	0.91	1.200	0.700	1.65	0.600
P52TM25-242-17	2.4	17.00	8	1.70	0.91	1.200	0.700	1.65	0.650
P52TM25-102-20	1.0	20.00	7	1.70	0.91	1.200	0.700	1.65	0.650

- Note:
1. Inductance measured: 1KHz, 0.1Vrms
  2. Polarity: 1 and 4 are in phase
  3. Turns Ratio: 1:1 (1-2 to 4-3)
  4. ΔT of 35°C Temperature Rise at rated current

### DIMENSIONS (inch)

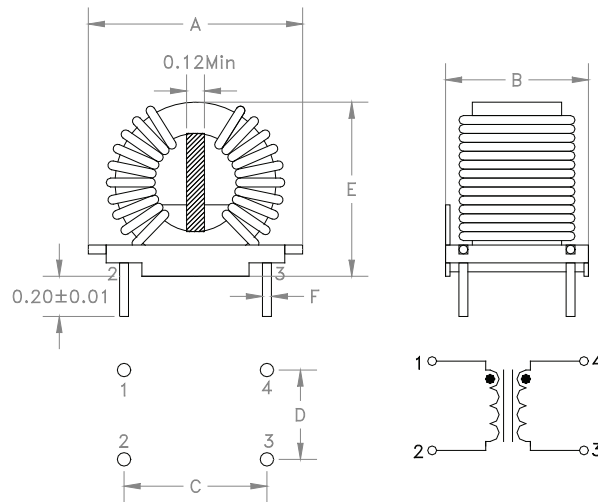

Product performance is limited to specified parameters. Data is subject to change without prior notice.

**Dimensions**  
 Unless otherwise specified, all tolerances are:  
 inch: .XX : ±0.008 .XXX : ±0.004  
 mm: X.X : ±0.20 X.XX : ±0.10

Tel: 310-325-1043  
 Fax: 310-325-1044

www.mpsind.com  
 sales@mpsind.com