

| Rev | Description | By | Date |
|-----|---|----|-----------|
| C | Changed Lead length added SRF and Capacitance | KA | 31-Aug-18 |
| D | Corrected pin dimensions and DC bias graph | AG | 17-Sep-20 |

ELECTRICAL SPECIFICATIONS @ 25°C

| | |
|-------------------|------------------------------------|
| L: | 2.2μH±15% @ 10kHz, 1Vrms |
| Isat: | ΔL ≤ 10% @174A ΔL ≤ 30% @308A |
| Irms: | ΔT ≤ 20°C @ 80A ΔT ≤ 40°C @122A |
| DCR: | 0.4mΩ Max |
| SRF: | 50 MHz |
| Capacitance: | 4.5 pF |
| Hipot: | 500Vdc, 1mA, 5s, wdg to core |
| Insulation Class: | Class H 180°C |
| RoHS Compliant: | Yes |

DIMENSIONS

Recommended PCB Layout

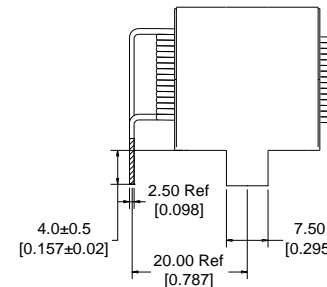
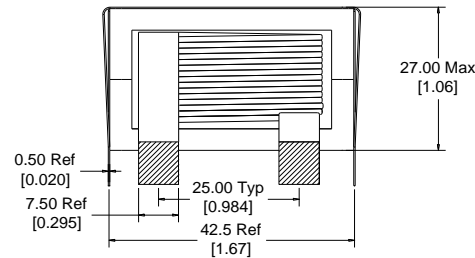
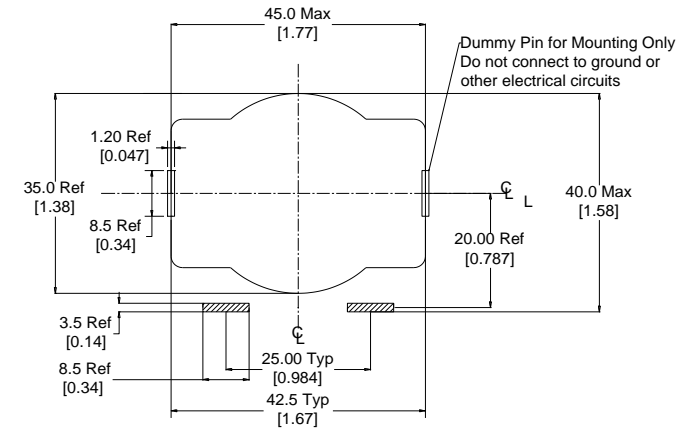
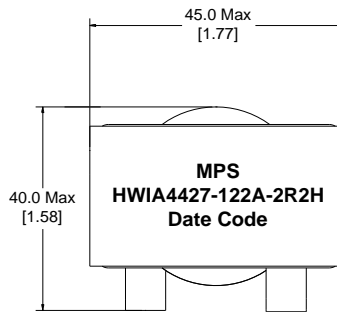

Dimensions: mm/[inch]

SCHEMATIC

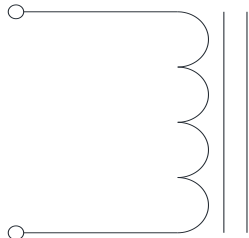

MARKING

MPS
HWIA4427-122A-2R2H_REV#
Date Code

Notice of Proprietary Property

These drawings and specifications are the property of MPS and shall not be, reproduced, copied or used as the basis of manufacture or sale of apparatus without express written authorization

| | | | | |
|---|--------------------------|-----------|------------------------|------------------|
| Dimensions Unless otherwise specified .XX ± 0.254mm [.010"] .XXX ± 0.13mm [.005"] | DRAWN BY: CHECKED BY: | MIG KC | 17-Mar-16 18-Mar-16 | SIZE A |
|---|--------------------------|-----------|------------------------|------------------|



MPS INDUSTRIES, INC.

www.mpsind.com

Tel: (310) 325-1043 Fax: (310) 325-1044

Description

Helical Wound Inductor

Part Number

HWIA4427-122A-2R2H

REV

D

WEIGHT: 190 gms

SHEET: 1 OF 2

| Rev | Description | By | Date |
|-----|---|----|-----------|
| C | Changed Lead length added SRF and Capacitance | KA | 31-Aug-18 |
| D | Corrected pin dimensions and DC bias graph | AG | 17-Sep-20 |

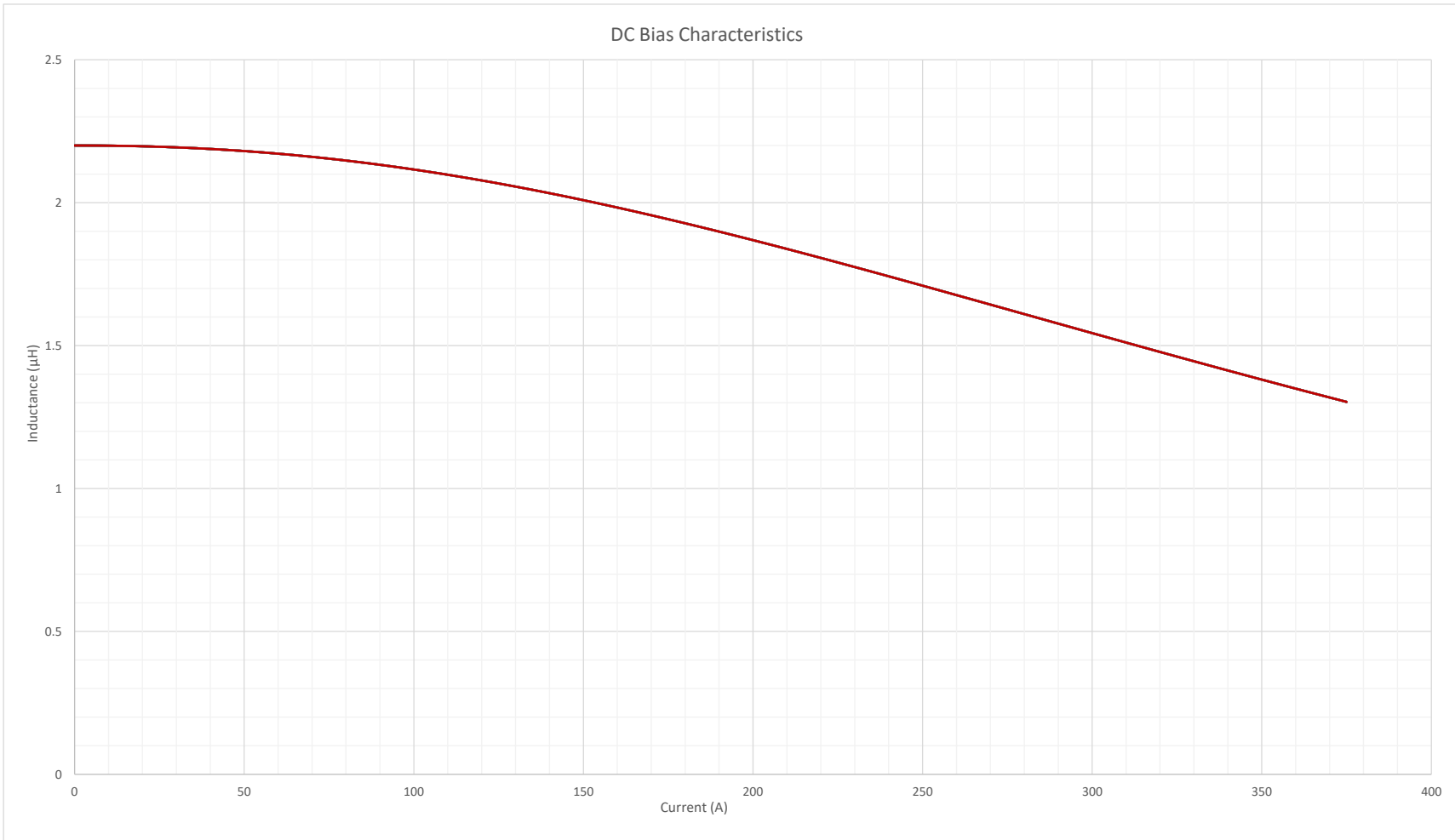

Notice of Proprietary Property

These drawings and specifications are the property of MPS and shall not be reproduced, copied or used as the basis of manufacture or sale of apparatus without express written authorization



MPS INDUSTRIES, INC.

www.mpsind.com

Tel: (310) 325-1043 Fax: (310) 325-1044

| | | | |
|-------------|---------------------------|-------------------------------|-----|
| Description | | Helical Wound Inductor | |
| Part Number | HWIA4427-122A-2R2H | | REV |
| | D | | |

| | | | | |
|---|-------------|-----|-----------|------------|
| Dimensions Unless otherwise specified | DRAWN BY: | MIG | 17-Mar-16 | SIZE |
| .XX ± 0,254mm [.010"] | CHECKED BY: | KC | 18-Mar-16 | A |
| .XXX ± 0,13mm [.005"] | | | | SCALE: X:X |

WEIGHT: 190 gms

SHEET: 2 OF 2