

Rev	Description	By	Date
C	Added SRF, capacitance, shortened lead size	KA	31-Jul-18
D	Corrected pin dimensions and DC bias graph	AG	17-Sep-20

ELECTRICAL SPECIFICATIONS @ 25°C

L:	30μH±15% @ 10kHz, 1Vrms
Isat:	ΔL ≤ 10% @46A ΔL ≤ 30% @82A
Irms:	ΔT ≤ 20°C @ 25A ΔT ≤ 40°C @ 38A
DCR:	4.2mΩ Max
SRF:	7.6 MHz Typ
Capacitance:	14.6 pF
Hipot:	500Vdc, 1mA, 5s, wdg to core
Insulation Class:	Class H 180° C
RoHS Compliant:	Yes

DIMENSIONS

Recommended PCB Layout

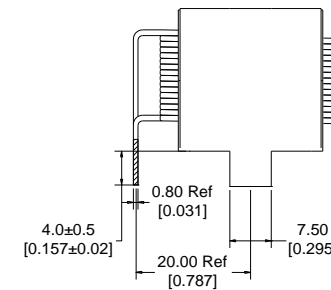
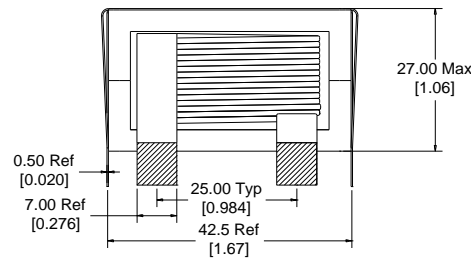
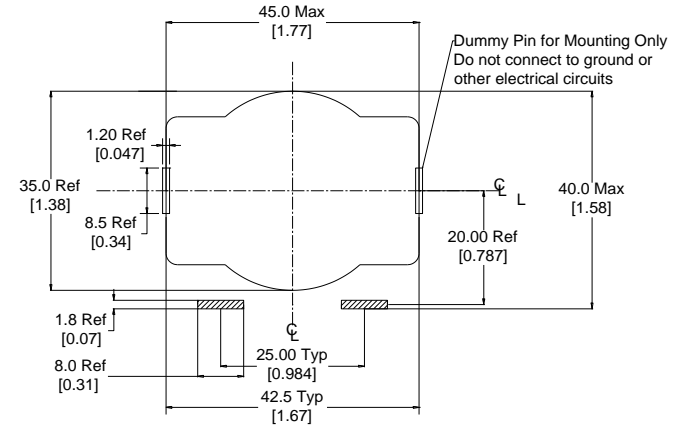
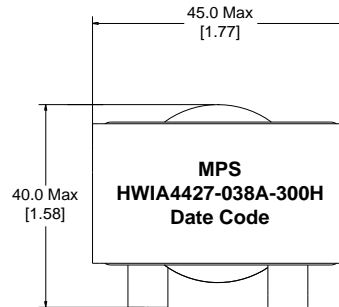

Dimensions: mm/[inch]

SCHEMATIC

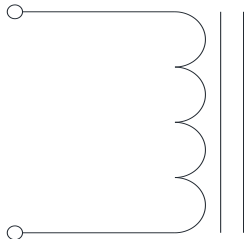

MARKING

MPS
HWIA4427-038A-300H_REV#
Date Code

Notice of Proprietary Property

These drawings and specifications are the property of MPS and shall not be, reproduced, copied or used as the basis of manufacture of sale of apparatus without express written authorization

Dimensions Unless otherwise specified .XX ± 0.254mm [.010"] .XXX ± 0.13mm [.005"]		DRAWN BY: CHECKED BY:	MIG KC	17-Mar-16 18-Mar-16	SIZE A	Part Number HWIA4427-038A-300H	REV D
WEIGHT: 190 gms						SHEET: 1 OF 2	



MPS INDUSTRIES, INC.

www.mpsind.com

Tel: (310) 325-1043 Fax: (310) 325-1044

Description

Helical Wound Inductor

Rev	Description	By	Date
C	Added SRF, capacitance, shortened lead size	KA	31-Jul-18
D	Corrected pin dimensions and DC bias graph	AG	17-Sep-20

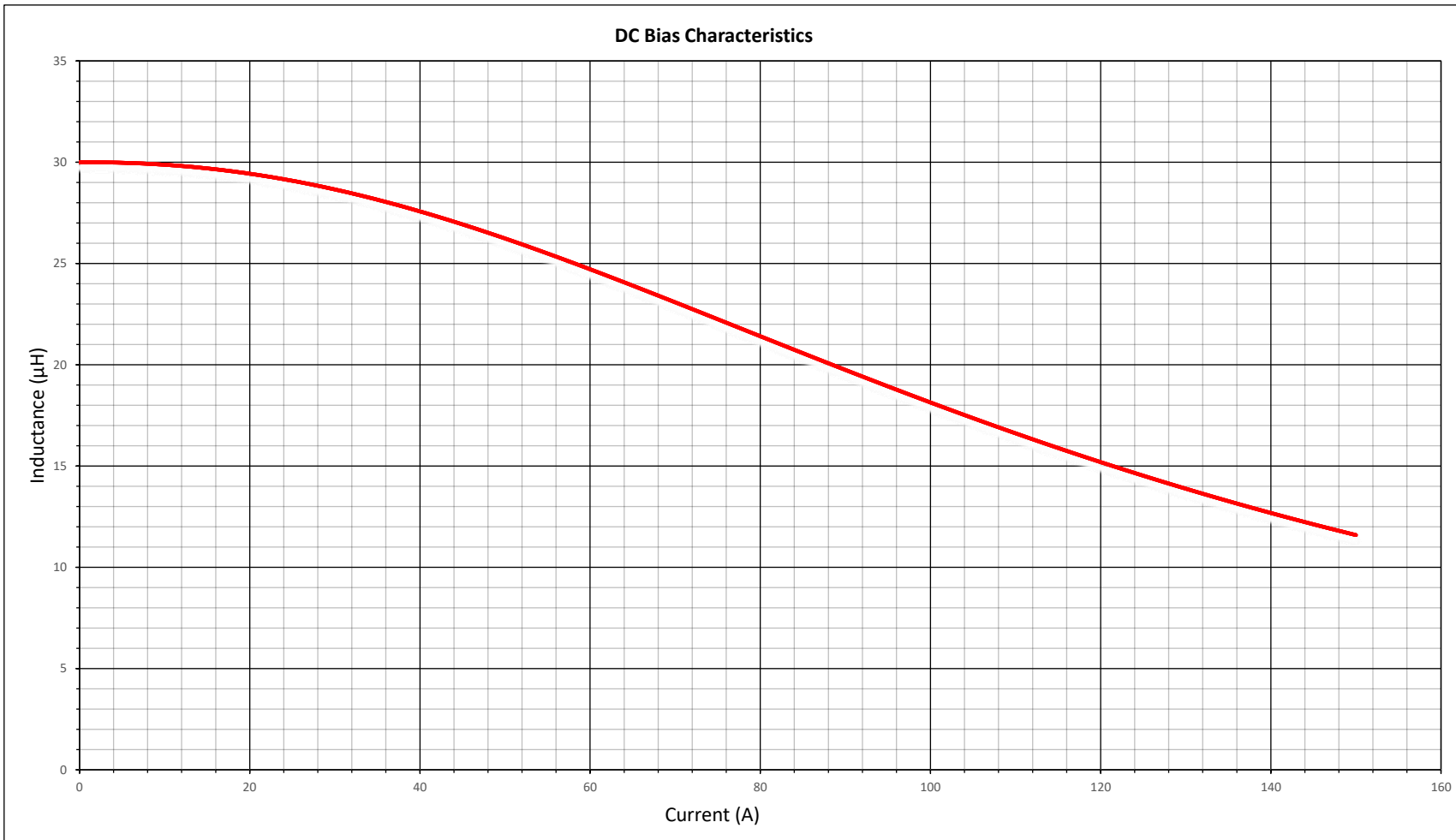

Notice of Proprietary Property

These drawings and specifications are the property of MPS and shall not be reproduced, copied or used as the basis of manufacture of sale of apparatus without express written authorization



MPS INDUSTRIES, INC.

www.mpsind.com

Tel: (310) 325-1043 Fax: (310) 325-1044

Description

Helical Wound Inductor

Dimensions
Unless otherwise specified
.XX ± 0.254mm [.010"]
.XXX ± 0.13mm [.005"]

DRAWN BY:
CHECKED BY:

MIG
KC

17-Mar-16
18-Mar-16

SIZE
A

Part Number

HWIA4427-038A-300H

REV

D

SCALE: X:X

WEIGHT: 190 gms

SHEET: 2 OF 2