

Rev	Description	By	Date
1	Preliminary	SO	7-Jul-23

ELECTRICAL SPECIFICATIONS @ 25°C

L: 26µH±15% @ 100kHz, 1Vrms
 Isat: ΔL≤10% @ 55A
 ΔL≤20% @ 83A
 ΔL≤30% @ 107A
 Irms: ΔT≤20°C @ 67A
 ΔT≤40°C @ 101A
 DCR: 1.5mΩ Max
 SRF: 11.5MHz Typ
 Hipot: 2kVdc, 1mA Max, 10s (wdg to case)
 Insulation Class: Class H, 180°C Min
 RoHS Compliant: Yes

DIMENSIONS

Recommended PCB Layout

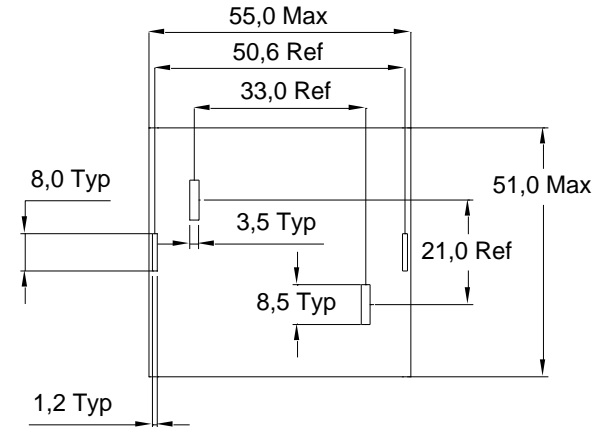
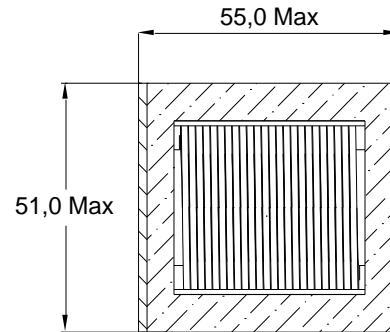

SCHEMATIC

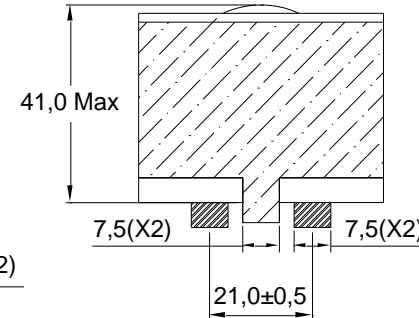
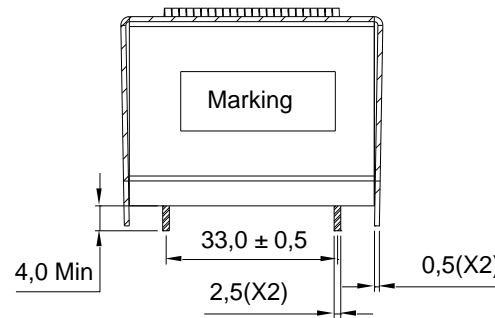
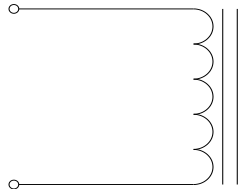

Dimensions: mm

MARKING

MPS
 HWI5252-101A-260V_ Rev#
 Date Code

Notice of Proprietary Property
 These drawings and specifications are the property of MPS and shall not be, reproduced, copied or used as the basis of manufacture of sale of apparatus without express written authorization

Dimensions Unless otherwise specified .XX ± .010" [0,254mm] .XXX ± .005" [0,13mm]	DRAWN BY: CHECKED BY:	SO SO	16-Aug-23 16-Aug-23	SIZE A
---	--------------------------	----------	------------------------	------------------



MPS INDUSTRIES, INC.

www.mpsind.com

Tel: (310) 325-1043 Fax: (310) 325-1044

Description High Power Inductor		REV 1
Part Number HWI5252-101A-260V	WEIGHT: xx gms SHEET: 1 OF 2	

Rev	Description	By	Date
1	Preliminary	SO	7-Jul-23

DC BIAS

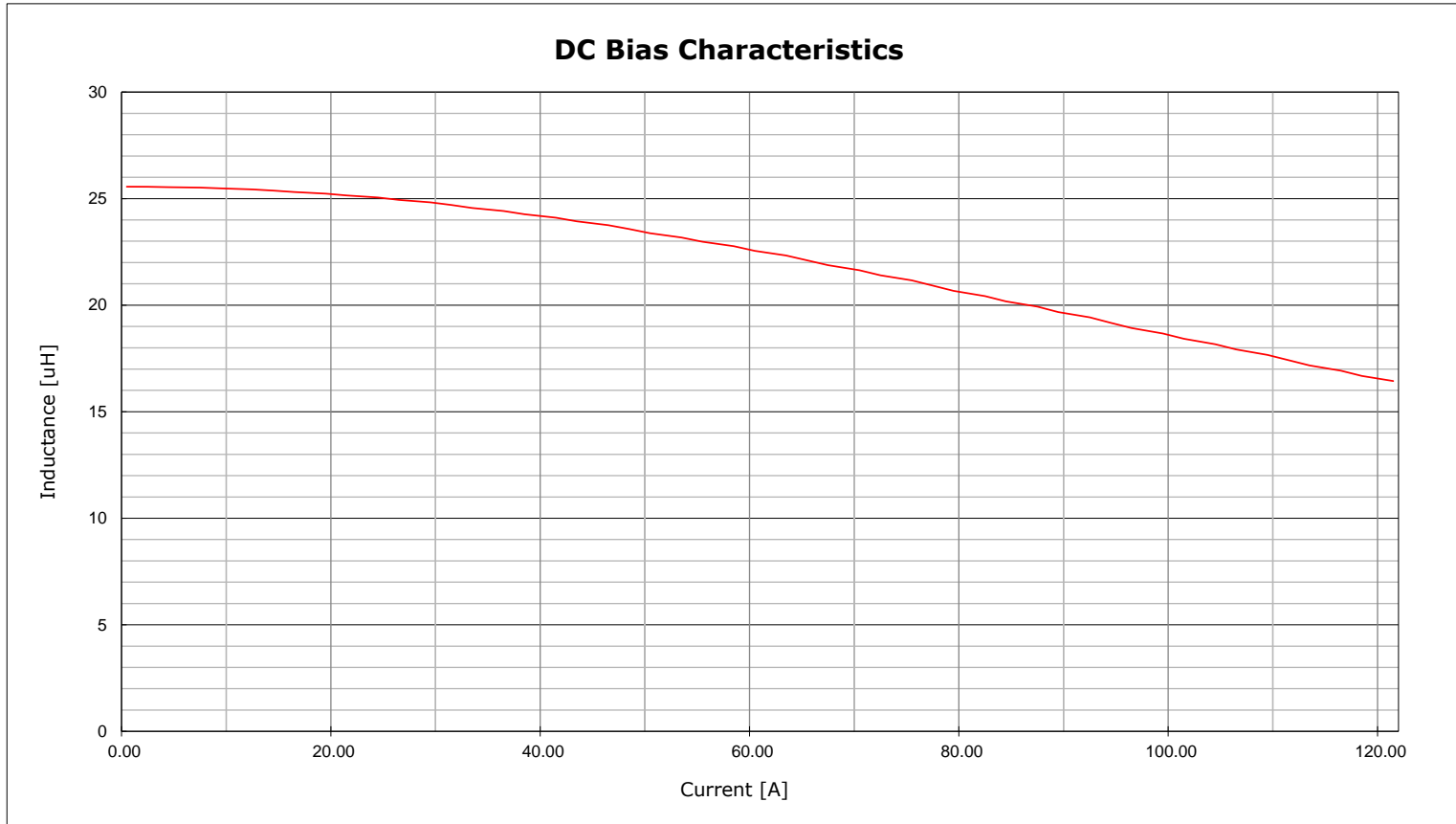

Notice of Proprietary Property

These drawings and specifications are the property of MPS and shall not be, reproduced, copied or used as the basis of manufacture of sale of ap AG without express written authorization

7/21/2017

7/21/2017

Dimensions	DRAWN BY:	SO	16-Aug-23	SIZE
Unless otherwise specified	CHECKED BY:	SO	16-Aug-23	A
.XX ± .010" [0,254mm]				
.XXX ± .005" [0,13mm]				

		MPS INDUSTRIES, INC. www.mpsind.com Tel: (310) 325-1043 Fax: (310) 325-1044	
Description		High Power Inductor	
Part Number		HWI5252-101A-260V	
SCALE: X:X	WEIGHT: 800 gms	SHEET: 2 OF 2	REV 1