

Rev	Description	By	Date
1	Preliminary	SO	7-Jul-23

**ELECTRICAL SPECIFICATIONS @ 25°C**

L: 160μH±15% @ 100kHz, 1Vrms  
 Isat: ΔL≤10% @ 22A  
 ΔL≤20% @ 32A  
 ΔL≤30% @ 42A  
 Irms: ΔT≤20°C @ 26.5A  
 ΔT≤40°C @ 40.5A  
 DCR: 9mΩ Max  
 SRF: 3.5MHz Typ  
 Hipot: 2kVdc, 1mA Max, 10s (wdg to case)  
 RoHS Compliant: Yes

**DIMENSIONS**

**Recommended PCB Layout**

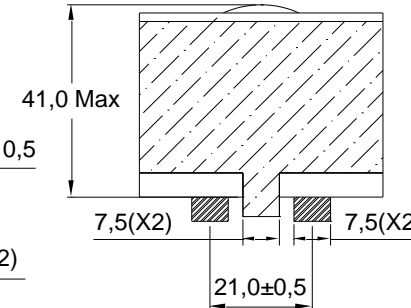
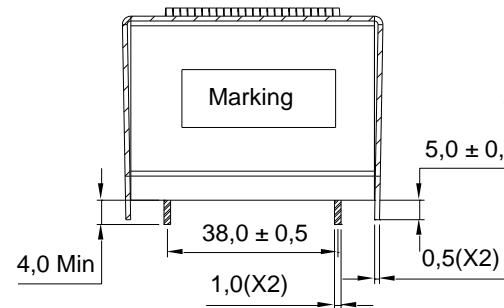
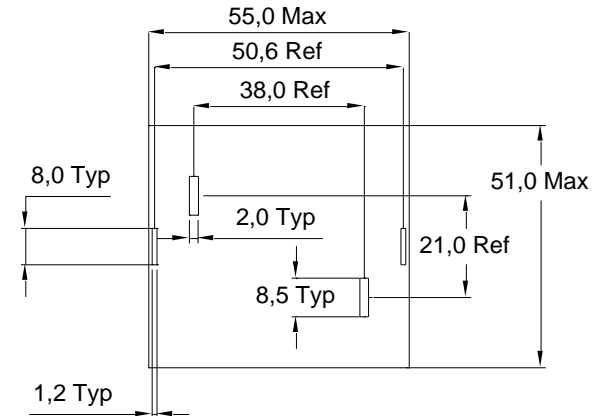
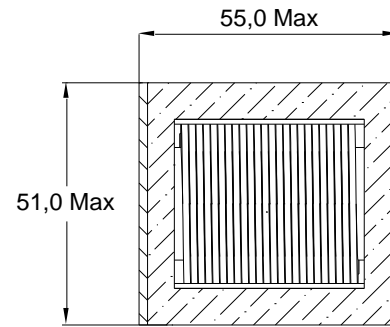

Dimensions: mm

**SCHEMATIC**

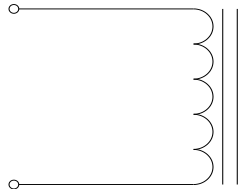

**MARKING**

MPS  
 HWI5252-040A-161V\_Rev#  
 Date Code

**Notice of Proprietary Property**

These drawings and specifications are the property of MPS and shall not be, reproduced, copied or used as the basis of manufacture of sale of apparatus without express written authorization

<b>Dimensions</b> Unless otherwise specified .XX ± .010" [0,254mm] .XXX ± .005" [0,13mm]	DRAWN BY: CHECKED BY:	SO SO	16-Aug-23 16-Aug-23	SIZE <b>A</b>
---	--------------------------	----------	------------------------	------------------



MPS INDUSTRIES, INC.

[www.mpsind.com](http://www.mpsind.com)

Tel: (310) 325-1043 Fax: (310) 325-1044

Description

**High Power Inductor**

Part Number

**HWI5252-040A-161V**

REV

**1**

WEIGHT: xx gms

SHEET: 1 OF 2

Rev	Description	By	Date
1	Preliminary	SO	7-Jul-23

**DC BIAS**

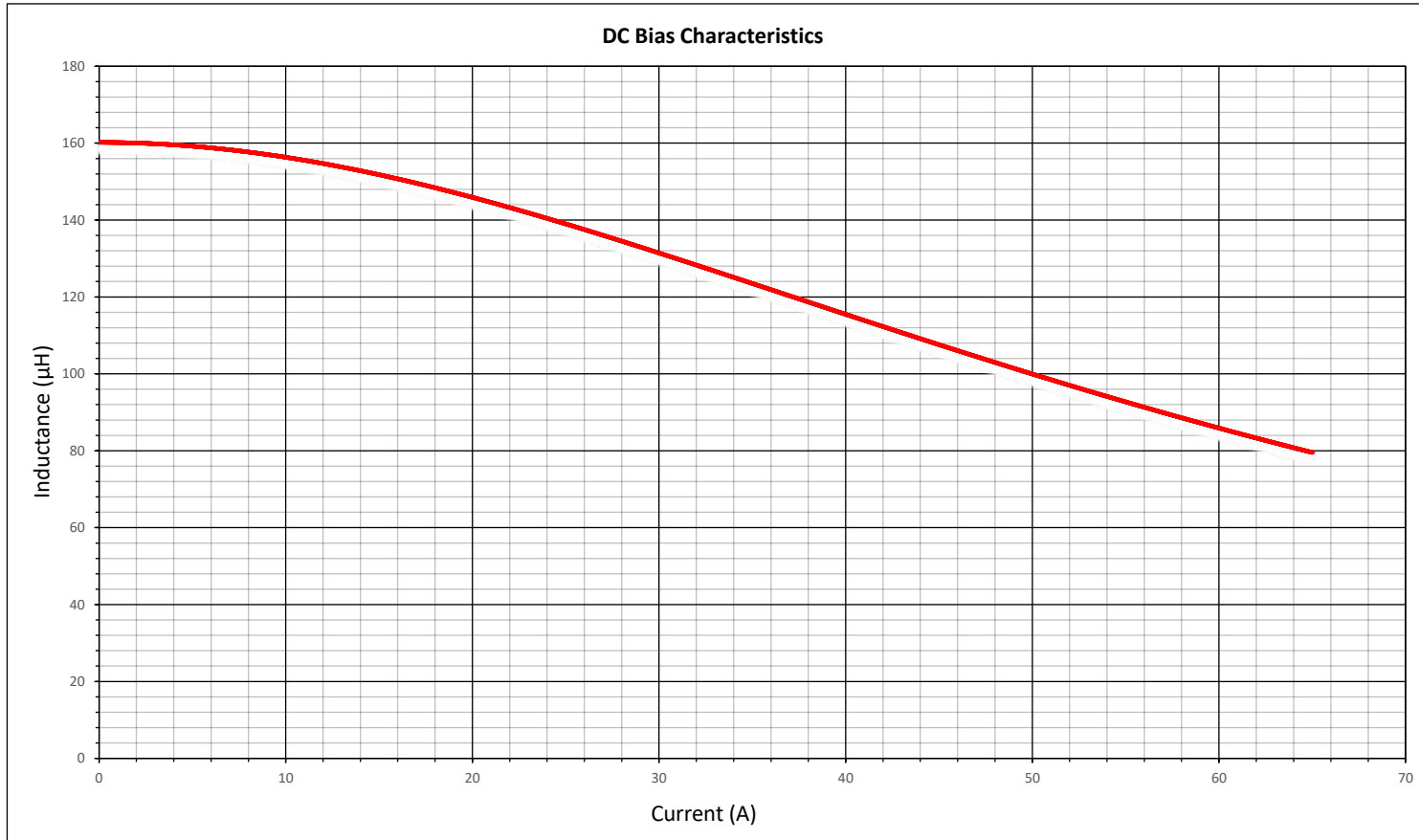

**Notice of Proprietary Property**

These drawings and specifications are the property of MPS and shall not be, reproduced, copied or used as the basis of manufacture of sale of ap AG without express written authorization

**Dimensions**  
 Unless otherwise specified  
 .XX ± .010" [0,254mm]  
 .XXX ± .005" [0,13mm]

DRAWN BY:  
 CHECKED BY:

SO 16-Aug-23  
 SO 16-Aug-23

7/21/2017  
 7/21/2017

SIZE  
**A**

SCALE: X:X



**MPS INDUSTRIES, INC.**  
 www.mpsind.com  
 Tel: (310) 325-1043 Fax: (310) 325-1044

Description

**High Power Inductor**

Part Number

**HWI5252-040A-161V**

REV

**1**

WEIGHT: 800 gms

SHEET: 2 OF 2