

Rev	Description	By	Date
B	Changed Terminal Position	MIG	10-Nov-15
C	Updated enclosure and inductance to +/-15%	AG	30-Dec-19

### ELECTRICAL SPECIFICATIONS @ 25°C

L: 78μH±15% @ 100kHz, 1Vrms  
 Isat: ΔL≤10% @ 31A  
       ΔL≤20% @ 47A  
       ΔL≤30% @ 61A  
 Irms: ΔT≤20°C @ 39A  
       ΔT≤40°C @ 59A  
 DCR: 4.2mΩ Max  
 SRF: 6.2MHz Typ  
 Hipot: 2kVdc, 1mA Max, 10s (wdg to case)  
 RoHS Compliant: Yes

### DIMENSIONS

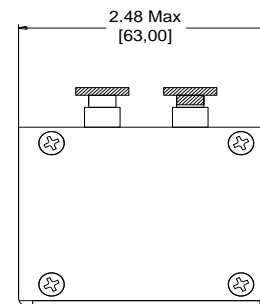
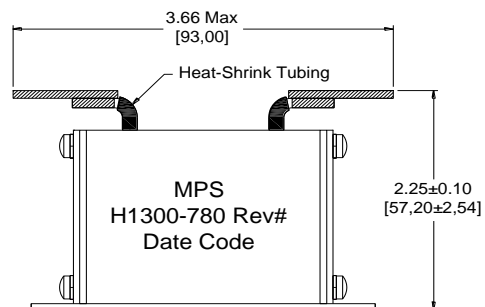
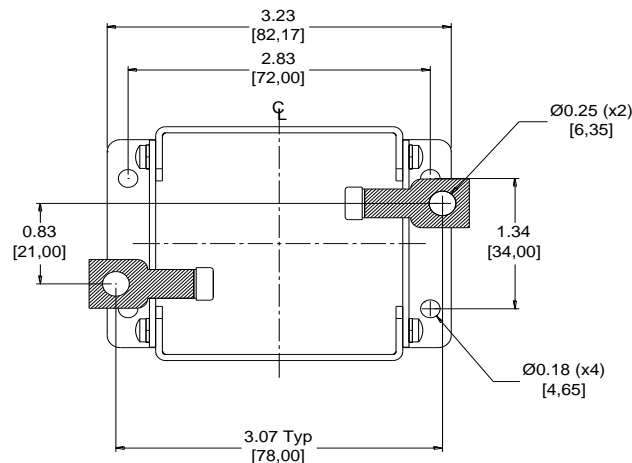

Dimensions: inch/[mm]

### SCHEMATIC

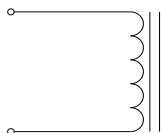

### MARKING

MPS  
 H1300-780 Rev#  
 Date Code



MPS INDUSTRIES, INC.

[www.mpsind.com](http://www.mpsind.com)

Tel: (310) 325-1043 Fax: (310) 325-1044

#### Notice of Proprietary Property

These drawings and specifications are the property of MPS and shall not be, reproduced, copied or used as the basis of manufacture of sale of apparatus without express written authorization

Description

**High Power Inductor**

<b>Dimensions</b> Unless otherwise specified .XX ± .010" [0,254mm] .XXX ± .005 [0,13mm]	DRAWN BY: CHECKED BY:	MIG AG	10-Nov-15 10-Nov-15	SIZE <b>A</b>	Part Number	REV
					<b>H1300-780</b>	
WEIGHT: XX gms					SHEET: 1 OF 2	

Rev	Description	By	Date
B	Changed Terminal Position	MIG	10-Nov-15
C	Updated enclosure and inductance to +/-15%	AG	30-Dec-19

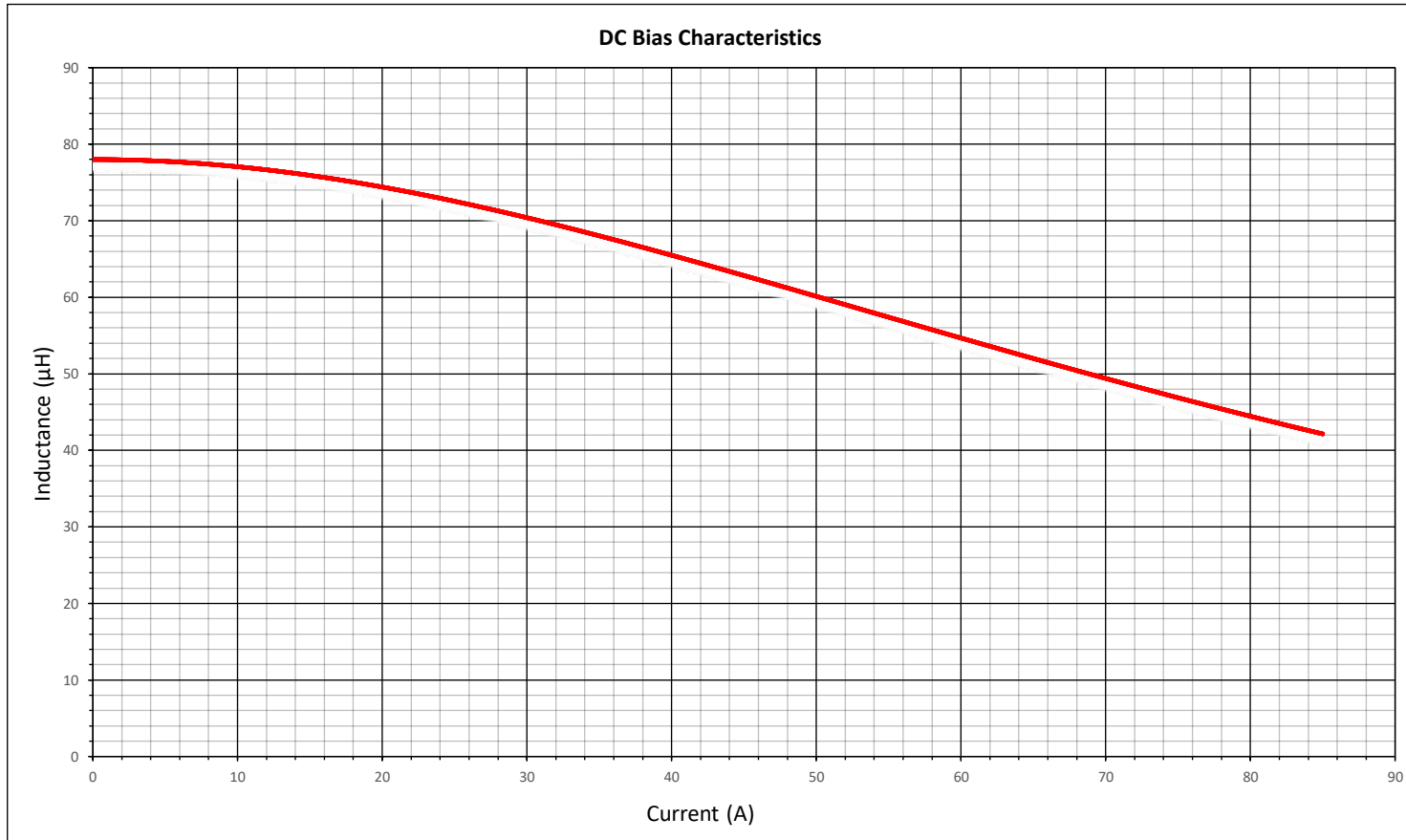

**Notice of Proprietary Property**

These drawings and specifications are the property of MPS and shall not be reproduced, copied or used as the basis of manufacture of sale of apparatus without express written authorization

**Dimensions**  
 Unless otherwise specified  
 .XX ± .010" [0,254mm]  
 .XXX ± .005 [0,13mm]

DRAWN BY:  
 CHECKED BY:

MIG  
 AG

10-Nov-15  
 10-Nov-15

SIZE  
**A**

Part Number

**High Power Inductor**

**H1300-780**

SCALE: X:X

WEIGHT: XX gms

SHEET: 2 OF 2

REV  
**C**



**MPS INDUSTRIES, INC.**

www.mpsind.com

Tel: (310) 325-1043 Fax: (310) 325-1044